



Features

- Can be used in hazardous locations exposed to moisture, dirt, dust, corrosion, vibration, or harsh conditions such as wind, water, snow, or high ambient temperatures
- Compact and rugged structure, easy to install
- Four kinds of driver covers available for different installation needs
- Optional emergency function
- Shock and vibration resistance with IK08/IK10 certified and 3G vibration test
- Aluminum housing, great corrosion resistance and cooling performance
- Optional wire guard

Compliance

- UL 844 Hazardous Locations:
 - Class I Division 2, Groups A, B, C, D
 - Class II Division 1, Groups E, F, G
 - Class II Division 2, Groups F, G
 - Class III
- Class I, Zone 2, Groups IIA, IIB, IIC
- Zone 21 or 22
- DLC (Pending)
- UL 1598
- UL 1598A
- ABS

Specifications

ELECTRICAL	
Rated Power	20W / 40W / 50W / 60W / 80W / 100W / 120W / 150W / 180W / 200W
Input Voltage – Normal	100–277 / 200–480 VAC
Input Voltage – Emergency	120–277 VAC
Input Frequency	50/60 Hz
Power Factor	>0.95

OPTICAL	
Lumen Output	2600–23,400 Lm @Max. 180W; 24,000 Lm @200W
Lumens Per Watt	130 Lm/W @Max. 180W; 120 Lm/W @200W
CCT	3000K / 4000K / 5000K / 5700K / 6500K
CRI	>70
Beam Angle	40° / 60° / 90° / 120°
Dimming	0-10V dimming optional
ENVIRONMENTAL	
Ambient Operating Temperature	-40°C to +40°C / +50°C / +65°C (-40°F to +104°F / +122°F / +149°F)
MECHANICAL	
Housing Material	Copper-free aluminum
Diffuser (Optional)	Flat glass / Flat polycarbonate / Convex glass / Convex polycarbonate
Hardware	Stainless steel
Protection	IP66 IK08 (without wire guard) / IK10 (with wire guard) 1.5G vibration
Mounting	Ceiling, Surface, Pendant, Wall, Stanchion 25°
Cable Entries	3/4" NPT (standard); 1/2" NPT, M20 or M25 (optional)
WARRANTY	
Warranty	5-Year Standard Warranty

Models Available

MODEL	WATTAGE	LUMEN OUTPUT
2MEXL-HQ2-20	20 W	2600 Lm
2MEXL-HQ2-40	40 W	5200 Lm
2MEXL-HQ2-50	50 W	6500 Lm
2MEXL-HQ2-60	60 W	7800 Lm
2MEXL-HQ2-80	80 W	10,400 Lm
2MEXL-HQ2-100	100 W	13,000 Lm
2MEXL-HQ2-120	120 W	15,600 Lm
2MEXL-HQ2-150	150 W	19,500 Lm
2MEXL-HQ2-180	180 W	23,400 Lm
2MEXL-HQ2-200	200 W	24,000 Lm

Driver Box Cover Types

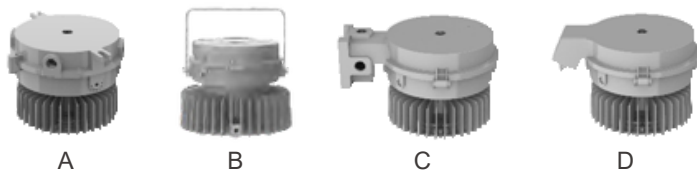

Packing Information

Cover Type	Net Weight*	Gross Weight*	Quantity/ Carton	Package Dimensions (L x W x H)
A	21.61 lb	26.02 lb	1 pc	17.72" x 17.72" x 13.78"
B	22.49 lb	26.90 lb		
C	22.49 lb	26.90 lb		
D	22.05 lb	26.46 lb		

*For models with flat glass diffuser and without wire guard.

4 Diffusers (Optional)



Different Mounting Kit Design



Note: The small hole in the center of the top is designed for backup. If it is unable to connect wires from the side of the fixture during installation, wires can be connected from this hole.

Light Distribution

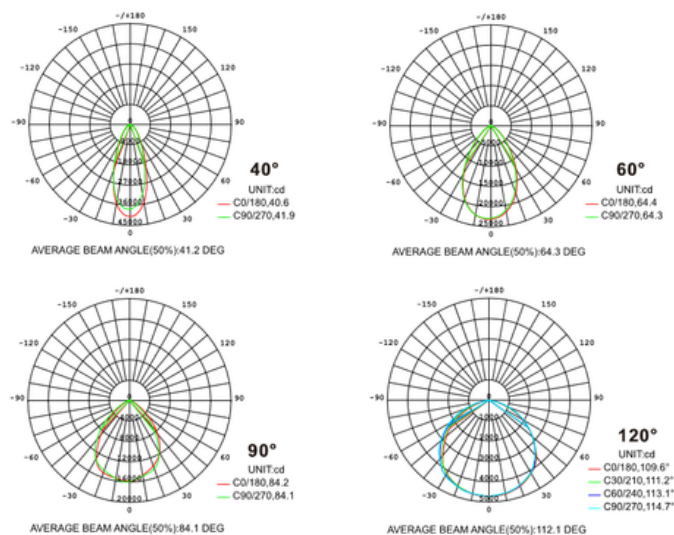

2 Surface Covers (Optional)

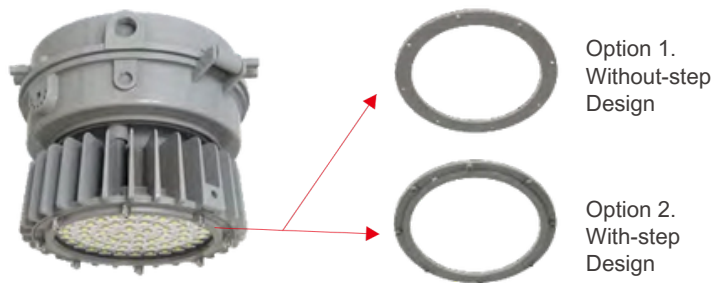

Mounting Methods and Accessories

•Option 1: Ceiling Mount

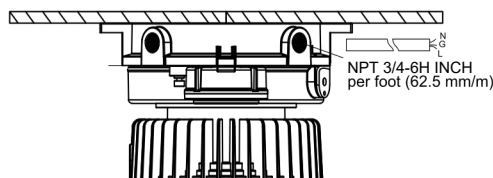

Note: Surface mounting is suitable for model with driver box cover A.



•Option 2: Wall Mount

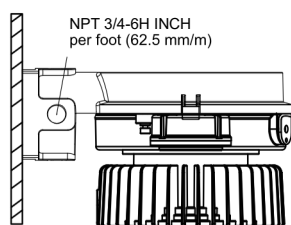

Note: Wall mounting is suitable for models with driver box cover C.

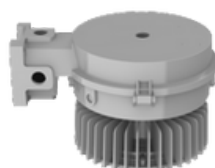

•Option 3: Stanchion 25° Mount

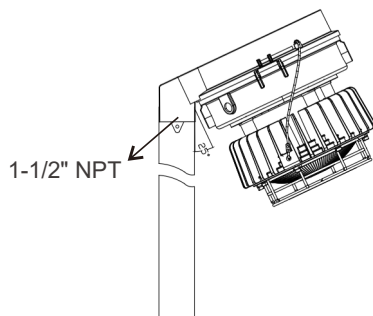

Note: 1. Stanchion mounting is suitable for models with driver box cover D.
2. The thread of the lamp pole interface is 1-1/2" NPT.



•Option 4: Pendant Mount

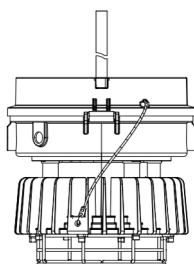

•Accessory (Ordered Separately)



Pole
Ex-Straight Pipe

Note: Pendant mounting is suitable for models with driver box cover B.



•Option 5: Surface Mount

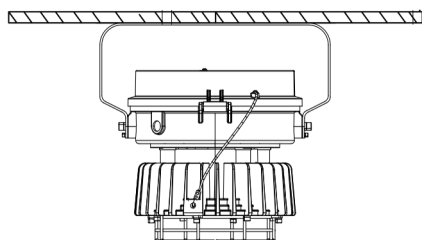

Note: 1. U bracket is standard accessory that is included in the packaging.
2. Surface mounting is suitable for models with driver box cover B.



Product Dimensions – mm [in]

Q2 with driver cover A and flat diffuser

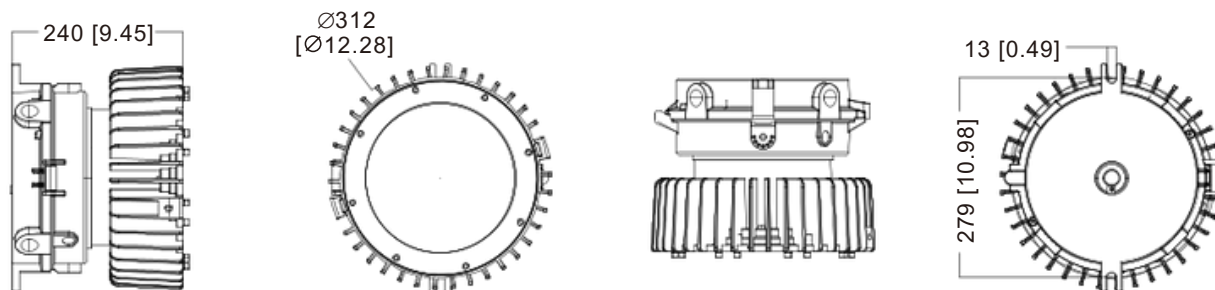

Q2 with driver cover B, wire guard, and flat diffuser

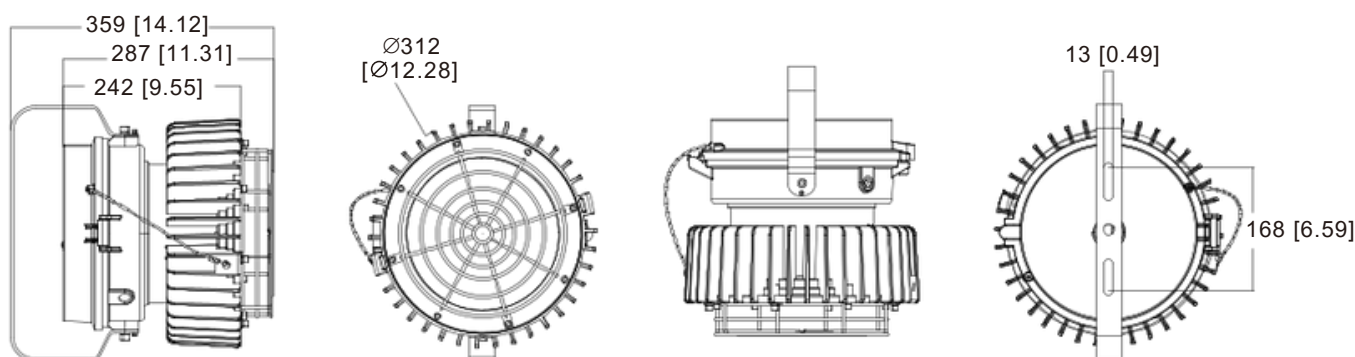

Q2 with driver cover B, wire guard, and convex diffuser (glass or PC)

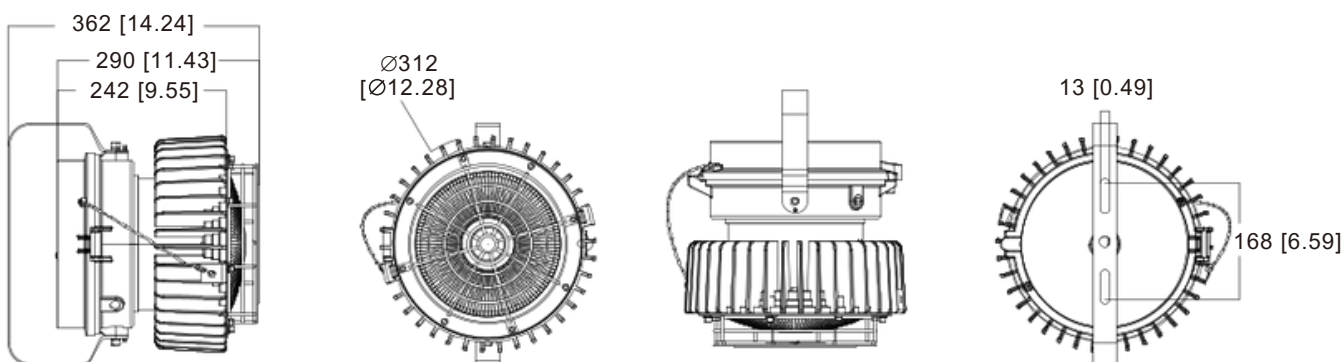

Product Dimensions – mm [in]

Q2 with driver cover C and flat diffuser

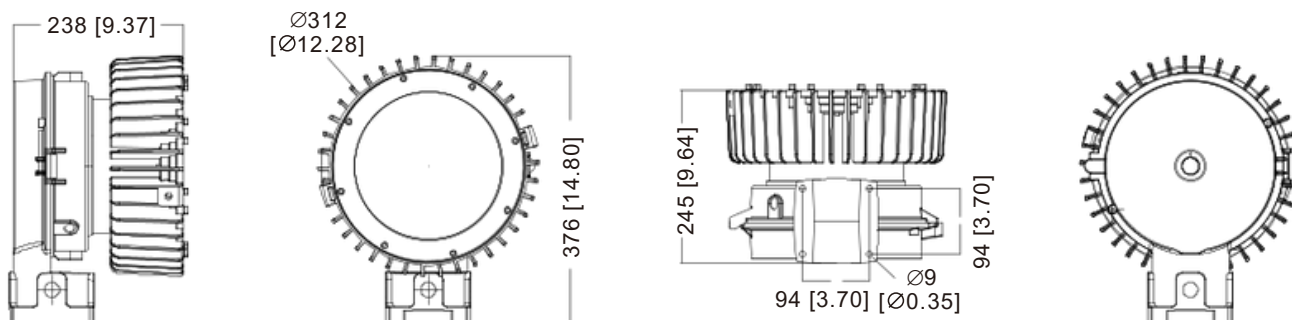

Q2 with driver cover D, wire guard, and flat diffuser

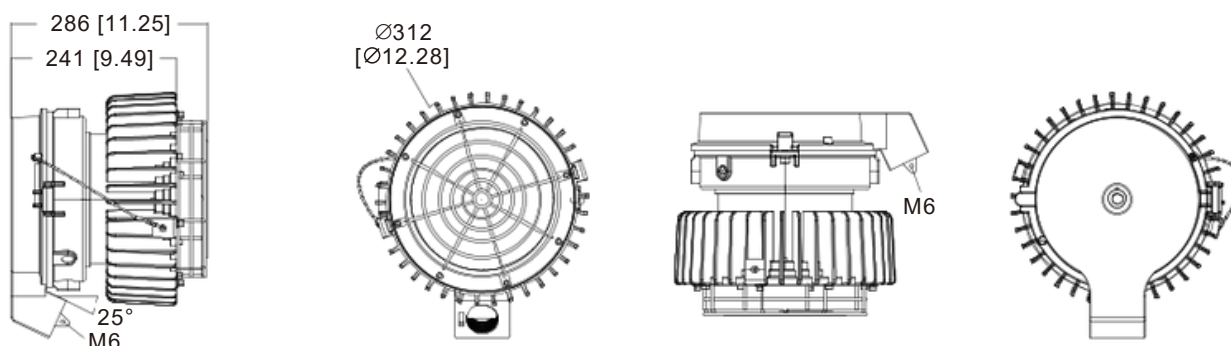

Q2 with driver cover D, wire guard, and convex diffuser (glass or PC)

